

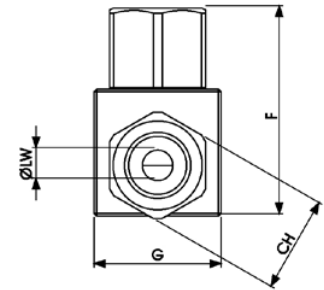

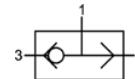



**7650**

**Wisselklep  
Valve de commutation  
Shuttle valve**

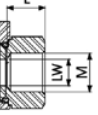

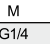

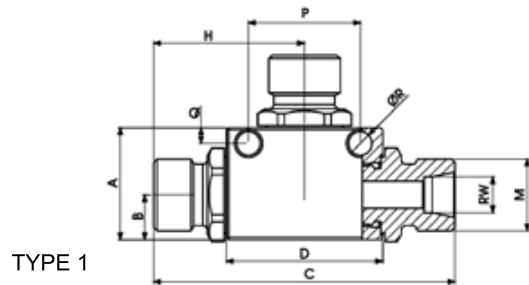

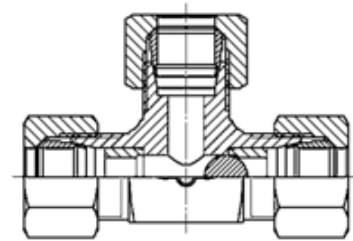

  BSPP	 DN	 M	A	C	D	F	G	L	LW	CH	 PN	REF.
												Fe
	6	G1/4	25	67	35	41	25	15,5	6	19	250	7650-04
	10	G3/8	40	78,6	50	54,3	35	15,5	10	30	250	7650-06
	13	G1/2	40	88,5	55	57,3	35	17	13	32	250	7650-08
	20	G3/4	55	107,5	75	71,5	45	21	20	41	250	7650-12
	25	G1	65	126	80	93	60	24	25	50	250	7650-16

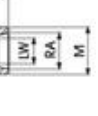

TYPE 1



TYPE 2

  BSPP	 DN	 M	A	C	D	F	G	L	LW	TYPE	CH	 PN	REF. L-serie
													Fe
	6	M14x1,5	25	67	35	41	25	6,7	6	1	19	160	7650-08L-BO
	10	M16x1,5	40	82,2	50	56,1	35	6,7	10	1	30	160	7650-10L-BO
	8	M18x1,5		64						2		160	7650-12L-BO
	13	M22x1,5	40	93,6	55	59	35	7	13	1	32	160	7650-15L-BO
	20	M30x2	55	122,3	75	78,5	50	7,5	20	1	41	160	7650-22L-BO
	25	M36x2	70	131	75	95	60	7,5	25	1	50	160	7650-28L-BO
													REF. S-serie
  BSPP	6	M16x1,5	25	67	35	41	25	7	6	1	19	160	7650-08S-BO
	6	M18x1,5		68						2		160	7650-10S-BO
	8	M20x1,5		76						2		160	7650-12S-BO
	10	M24x1,5								2		160	7650-16S-BO
	13	M30x2	40	99,5	55	62	35	10,5	13	1	32	160	7650-20S-BO
	20	M36x2	55	123,5	75	78,5	50	12	20	1	41	160	7650-25S-BO
	25	M42x2	70	134	75	97	60	13,5	25	1	50	160	7650-30S-BO

RVS op aanvraag - Acier inoxydable sur demande - Stainless steel on request

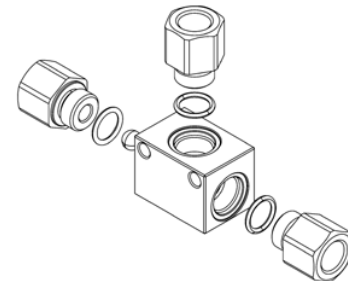
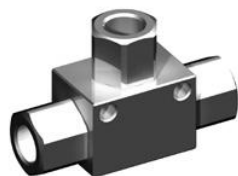

HYDROFLEX HYDRAULICS B.V.  
 t. +31 (0)186 620777  
 f. +31 (0)186 616007  
 e. sales@hydroflex.nl

HYDROFLEX HYDRAULICS BELGIUM N.V.  
 t. +32 (0)2 2674114  
 f. +32 (0)2 2674225  
 e. sales@hydroflex.be

HYDROFLEX HYDRAULICS ROTTERDAM B.V.  
 t. +31 (0)10 2839000  
 f. +31 (0)10 4952590  
 e. rotterdam@hydroflex.nl