

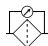

	max. 570 LPM (Visc. = 30cSt)
	-25/+110°C
	ΔP MAX. 1 BAR
	G1/2" ÷ G3"
	M90
	HH-HL-HM-HR-HV-HG, acc. ISO 6743/4

77201





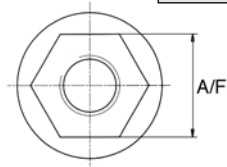
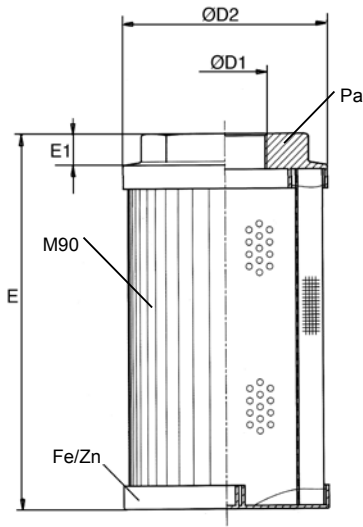

PUMP CARE

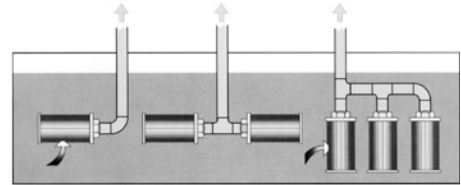
Zuigkorf
Crépine d'aspiration
Strainer

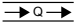

D1 BSPP	Ø D2	E	A/F	→ q → LPM Visc. = 30 cSt - s.g. 0,9 ΔP 0,02 BAR (2 kPa)	REF.
G1/2	46	106	30	15	77201-015-M090
G3/4	64	110	36	25	77201-025-M090
G1	64	140	46	50	77201-045-M090
G1.1/2	98	140	60	95	77201-075-M090
G1.1/2	98	178	60	110	77201-090-M090
G1.1/2	98	200	60	130	77201-115-M090
G2	98	260	70	180	77201-135-M090
G2	98	311	70	180	77201-180-M090
G2	98	331	70	220	77201-230-M090
G2	150	150	70	225	77201-232-M090
G2.1/2	150	212	90	350	77201-340-M090
G3	150	272	100	500	77201-450-M090
G3	150	352	100	570	77201-570-M090



	max. 500 LPM (Visc. = 30cSt)
	-25/+110°C
	ΔP MAX. 1 BAR
	G3/4" ÷ G3"
	M60-M90-M250-M600
	HH-HL-HM-HR-HV-HG, acc. ISO 6743/4

77202

PUMP CARE

Zuigkorf
Crépine d'aspiration
Strainer

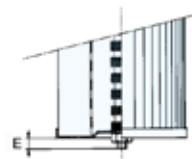
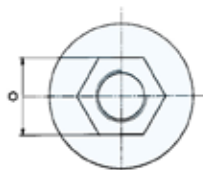
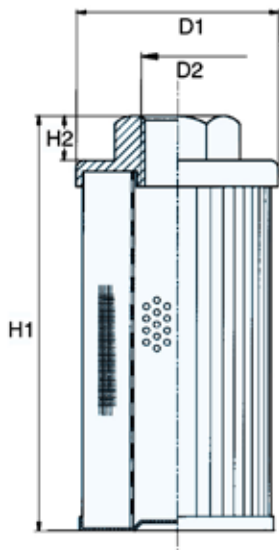

D1	D2	H1	H2	E	O	→ q → LPM Visc. = 30 cSt - s.g. 0,9 ΔP 0,03 BAR (3 kPa)	REF.
70	3/4	100	13	10	42	35	77202-00812-M090
70	3/4	10	13	10	42	35	77202-00812-M250
70	1	145	13	10	42	54	77202-01316-M060
70	1	145	13	10	42	60	77202-01316-M090
95	1.1/4	135	13	5,5	60	100	77202-02520-M060
95	1.1/4	135	13	5,5	60	110	77202-02520-M090
95	1.1/2	226	13	5,5	60	137	77202-04024-M060
140	1.1/2	226	13	5,5	60	150	77202-04024-M090
140	2	155	13	5,5	75	250	77202-06032-M090
140	2	155	13	5,5	75	250	77202-06032-M250
140	1.1/2	275	25	8	101	330	77202-08040-M090
140	1.1/2	275	25	8	101	330	77202-08040-M250
140	1.1/2	275	25	8	101	365	77202-08040-M600
140	3	325	25	8	101	500	77202-11548-M090

HYDROFLEX HYDRAULICS B.V.
t. +31 (0)186 620777
f. +31 (0)186 616007
e. sales@hydroflex.nl

HYDROFLEX HYDRAULICS BELGIUM N.V.
t. +32 (0)2 2674114
f. +32 (0)2 2674225
e. sales@hydroflex.be

HYDROFLEX HYDRAULICS ROTTERDAM B.V.
t. +31 (0)10 2839000
f. +31 (0)10 4952590
e. rotterdam@hydroflex.nl